

C.J. ANDERSON & CO. *Accu-Track Selector*

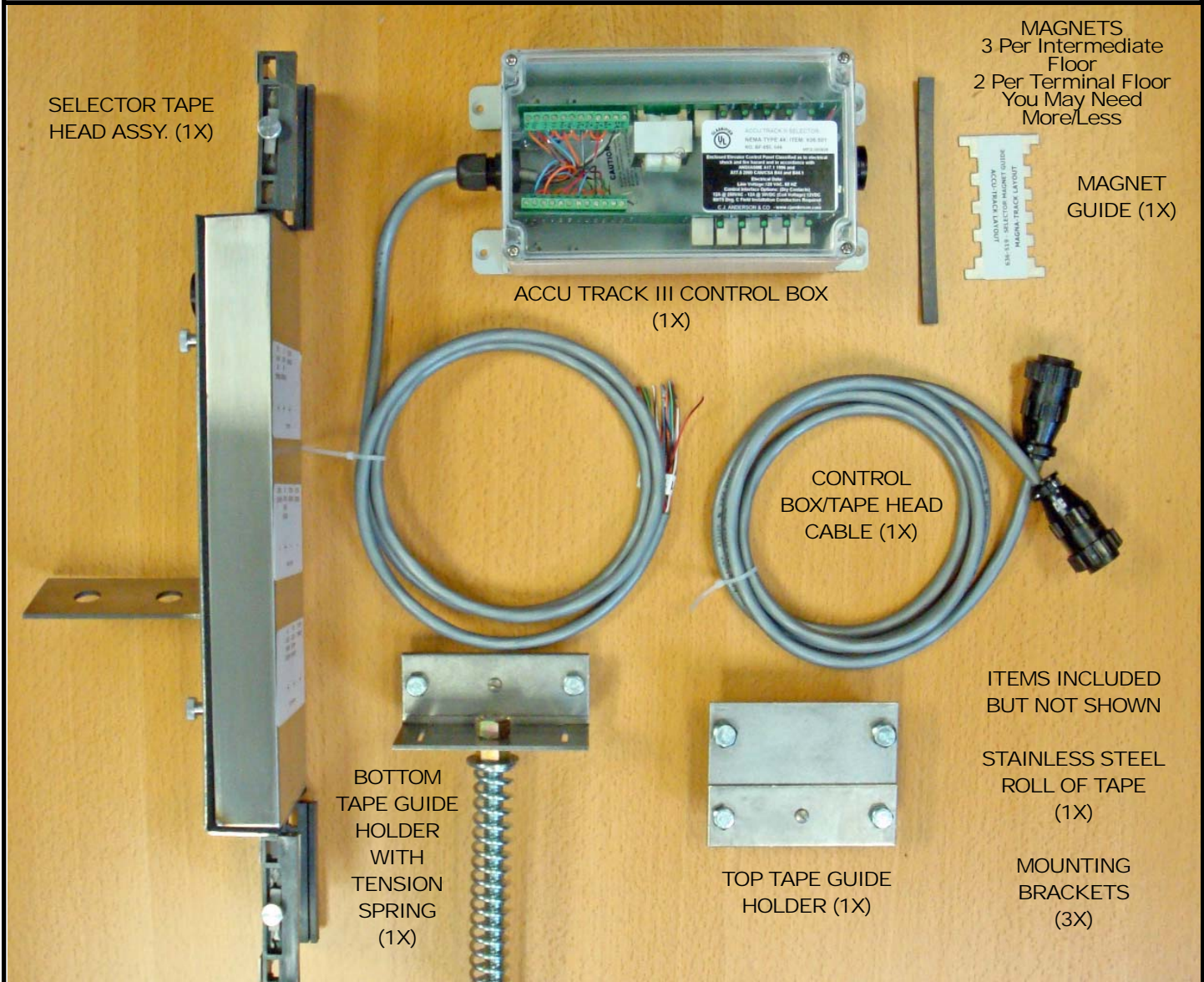

IMPORTANT WARNING

Technical Assistance - CJA staff personnel are available to answer any questions concerning the use or application of CJA products. However, any field changes made to the products are the sole responsibility of the user, unless authorized by CJA in the form of revised wiring diagrams or technical bulletins.

Maintenance of Products - All CJA products require scheduled periodic inspections, adjustments, lubrication and other routine maintenance actions. Non-performance of maintenance will nullify the product warranty.

LIMITS OF LIABILITY CJA's entire liability and the purchaser's exclusive remedy shall be as follows: In all situations, including performance or non-performance of the material ordered, the purchaser's remedy is that provided under the warranty provision. CJA's liability for loss of or damage to purchaser for any cause whatsoever and regardless of the form of action, contract or in tort, including negligence, shall be limited to the price of the part on which such liability is based. CJA will not be liable for any injury, special, direct or consequential damage, loss of time, profit or other losses, labor charges, repairs, expenses or other cost arising out of the incorrect use of, or the inability of the purchaser to use the product. Correction of any defects by repair or replacement by CJA shall constitute fulfillment of all obligations to the purchaser. In no event will CJA be responsible for any loss, damage or delay. In no event will CJA be liable for any damages caused by purchaser or for any lost profits or other special, incidental or consequential damages. CJA products are only warranted to function as designed and manufactured. If the product does not meet the purchasers' expectations or standards, the purchaser is still obligated to pay for the product in full.

WARRANTY - All CJA products are warranted to the original purchaser to be free from defects in material and workmanship for a period of one year from the date of shipment, provided they are (1) paid for, (2) installed as designed and (3) used for the purpose intended. This warranty will only be effective after notification from the purchaser of a product defect, return of the part freight prepaid, and after CJA inspection proves the part to be defective. CJA's total obligation under this warranty is to repair or replace free of charge defective products. If the product is determined to be out of warranty an estimate to repair will be sent to the purchaser.

Before using or furnishing to another for their use, the purchaser shall determine the suitability of the product for its intended use and purchaser assumes all risks and liabilities in connection therewith. Any unauthorized repairs or adjustments shall cancel this warranty and shall relieve the company from any further responsibility.

FOR A COMPLETE COPY OF OUR TERMS AND CONDITIONS PLEASE CALL 1-800-252-1910.

Item#: 636-501-3- Rev. A.

1

Mount Top Tape Guide - Install To Rail Using Strut & Brackets



Ensure that top tape mounting bracket is installed high enough that roller guides do not strike unit.

This unit is full adjustable.

2

Mount Bottom Tape Guide - Install To Rail Using Strut & Brackets



3

Mount Stainless Steel Tape To Top Tape Guide Holder



Slowly move elevator or unroll tape down the shaft way to the pit. Note that if tape kinks it will not work

4

Connect Bottom of Tape to Bottom Tape Guide Holder & Tension



Make certain that pushbutton is centered in hole to prevent dust and moisture from entering station. Do NOT over tighten and make sure that the tape is lined up.

5

Remove Tape Guides From Tape Head

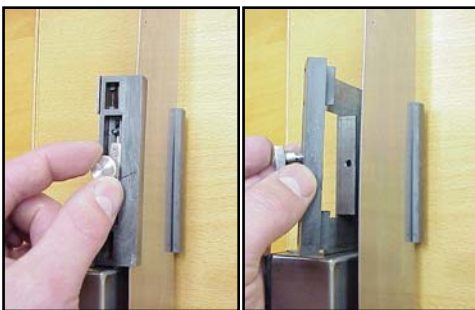

Note that you'll need to remove the tape guides to insert the tape.

6

Install Selector Head & Control Box - Wire To Junction Box

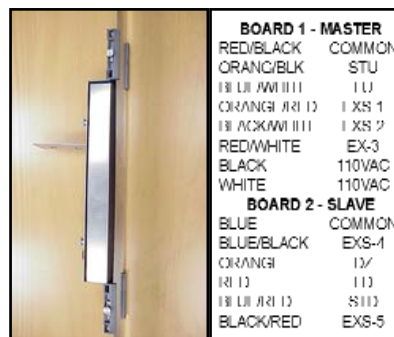

BOARD 1 - MASTER	
RED/BLACK	COMMON
ORANG/BLK	STU
BLU/WH IIII	11J
ORANG/WH 12	1 XS 1
BLK/WH IIII	1 XS 2
RED/WHITE	EX-3
BLACK	110VAC
WHITE	110VAC
BOARD 2 - SLAVE	
BLUE	COMMON
BLUE/BLACK	EXS-1
ORANG	13/
WH 12	11J
BLU/WH 12	5112
BLACK/RED	EXS-5

Note that the bracket that the top tape head is not shown in this photograph. Wire Control Box with 110VAC Power to board with transformer on it.

MAINTENANCE: - As with all moving parts this operator may require maintenance. The design and construction is intended for wet and dusty locations. These location may require that lubrication to the moving contact block parts be performed on regular basis. It is up to the elevator technician to determine how often to lubricate the moving components based on the environmental conditions and how severe they are.

7

Magnet Layout & Sensor Layout On Tape Head - Note Facing Stainless Steel Tape Where Magnets Will Mount

Magnet Layout - Without Encoding Feedback
While CJA Elevator Control Systems do not come equipped with floor encoding feed back it is available upon request. Each Accu-Track III is field wirable for encoder feedback functions. Please consult your selector magnet layout from your controller manufacturer as to where magnets need to be placed in order to accomplish floor encoding. Cut magnets shorter if required.

PLEASE NOTE THAT THIS SELECTOR SYSTEM REQUIRES 110VAC POWER TO OPERATE. DEPENDING ON THE MODEL, ENCODING OR NON ENCODING IT PROVIDES 5-10 DRY CONTACTS TO CONNECT TO YOUR CONTROLLER. THESE CONTACTS ARE RATED 250 VOLTS AC AT 12 AMP AND 30 VOLTS DC AT 12 AMP. THE RELAY COIL VOLTAGE IS 12 VOLTS DC

PLEASE CONSULT YOUR CONTROLLER PRINT FOR SPECIFIC CONNECTION INFORMATION.

CJA control systems will use the following sensors and tracks for all of it's control systems, unless floor encoding is requested.

- A Sensor = STU Up Slow Down - Positive Magnet
- B Sensor = LU (Level Up Sensor) - Positive Magnet
- C Sensor = Extra Sensor - Negative Magnet
- D Sensor = Extra Sensor - Negative Magnet
- E Sensor = DZ (Door Zone) - Positive Magnet
- F Sensor = Extra Sensor - Negative Magnet
- G Sensor = Extra Sensor
- H Sensor = LD (Level Down) - Positive Magnet
- I Sensor = STD - Down Slow Down - Positive Magnet
- J Sensor = Extra Sensor - Positive Magnet

Slow Down Magnet Positioning

Using the magnet layout comb align with the edge of tape. It will provide a guide for magnet layout of each track.

DOWN SLOWDOWN MAGNET – In the down slowdown row, or track 1, measure from the center of the leveling magnet up to the slowdown distance required for your job.

Note that the higher speed elevator the longer the slow down magnets need to be.

UP SLOWDOWN MAGNET – In the up slowdown row, or track 4, measure from the center of the leveling magnet up to the slowdown distance required for your job.

Note that the higher speed elevator the longer the slow down magnets need to be. Wire Unit according to wiring schematic on back of cover.

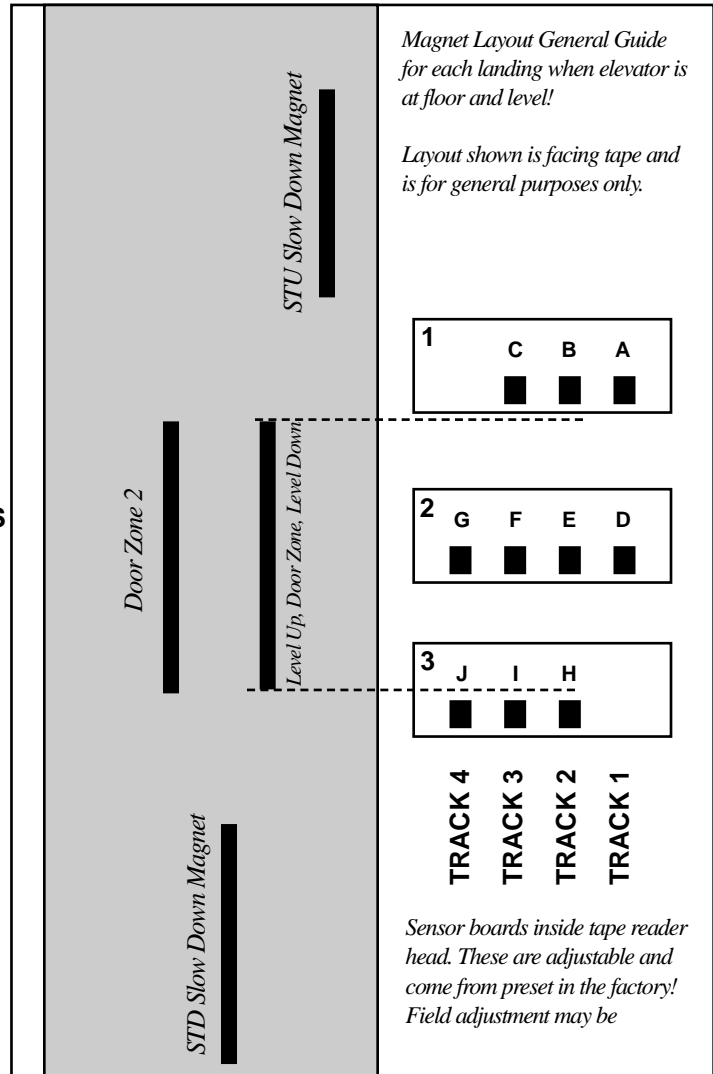

BOARD 1 - MASTER

RED/BLACK	COMMON
ORANG/BLK	STU
BLUE/WHITE	LU
ORANGE/RED	EXS-1
BLACK/WHITE	EXS-2
RED/WHITE	EX-3
BLACK	110VAC
WHITE	110VAC

BOARD 2 - SLAVE

BLUE	COMMON
BLUE/BLACK	EXS-4
ORANGE	DZ
RED	LD
BLUE/RED	STD
BLACK/RED	EXS-5

